

REV.	ZONE	LTR	DESCRIPTION	DATE	REVISER	APPD
4	B6	△	RENEW DRAWING	8/12-06	MWLIn	

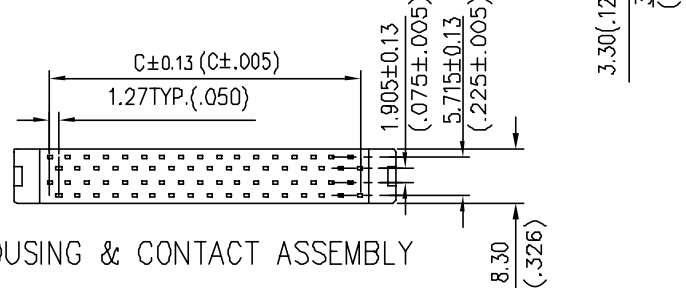

HOUSING & CONTACT ASSEMBLY

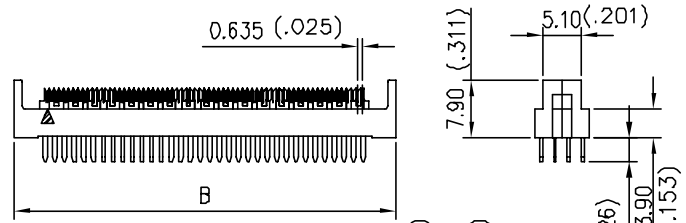
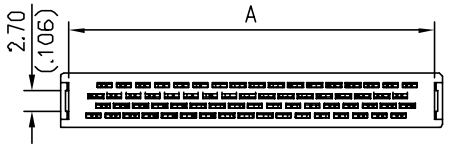
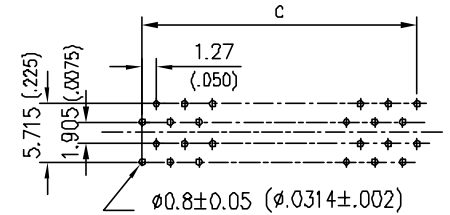

P.C.B LAYOUT

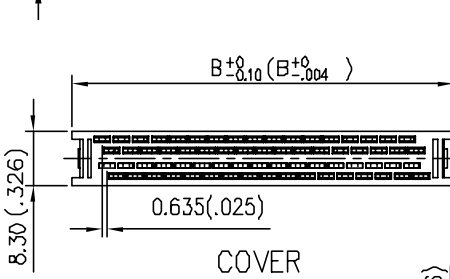
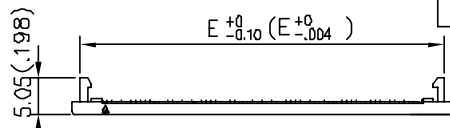

COVER

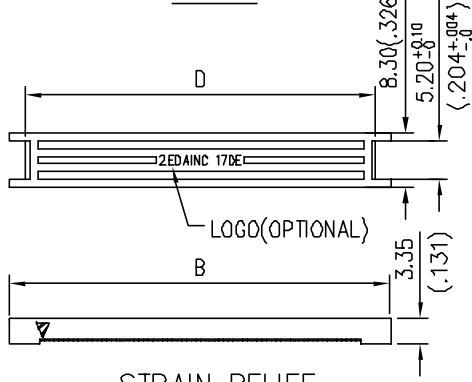

STRAIN RELIEF

△ ORDERING INFORMATION

17 DE — 080 3 T N * — 10
 (1) (2) (3) (4) (5) (6) (7) (8)

- SERIES NUMBER :
17: DIP CONNECTOR
- DE : 4ROWS 1.27(.050)*(.075) DIP'S
I.D.C 0.635(0.025")FLAT CABLE
- NO OF CONTACTS :
068 : 68 POSITIONS
080 : 80 POSITIONS
- COLOR (INSULATOR)
3 : BLACK
- CONTACT FINISH :
T : TIN PLATED
- STRAIN RELIEF
N: WITHOUT STRAIN RELIEF
- PIN 1 LOCATION
1 : PIN 1 ON 1ST CONDUCTOR OF CABLE
- LOGO WITH "2EDAINC" LOGO
00-WITHOUT LOGO

RoHS Compliant

NOTES:

- MATERIAL:
HOUSING : PBT&30%G/F REINFORCED ,UL 94V-0
STRAIN RELIEF : PBT&30%G/F REINFORCED,UL 94V-0
COVER : PBT&30%G/F REINFORCED,UL 94V-0
CONTACT : PHOSPHOR BRONZE,TIN PLATED OVER NICKEL
- SPECIFICATION
 - RATED CURRENT : 1A
 - INSULATION RESISTANCE : 1000MΩ MIN. AT 500V DC.
 - CONTACT RESISTANCE : 35mΩ MAX.
 - DIELECTRIC WITHSTANDING VOLTAGE : AC 250V FOR 1 MIN.
 - OPERATING TEMPERATURE : -25°C - +85°C.

56.82(2.237)	54.72(2.154)	49.53(1.950)	59.12(2.327)	56.92(2.24)	17DE-080****
49.20(1.937)	47.10(1.854)	41.91(1.650)	51.50(2.027)	49.30(1.940)	17DE-068****
E	D	C	B	A	PART NO.

MATERIAL	TOLERANCE UNSPECIFIED	FREEPORT	SCALE	UNIT		
	.0 0 0 ± .0 0 ± 0.25(.010) .0 ± 0.38(.015) . ± ANGLE ± 1°				NONE	mm(inch)
FINISH	DRAWN	Perry 03/23'2K	NAME	SHEET		
	DESIGNER	連進興 01/22'96			17DE SERIES SCSI-III H.D. I.D.C DIP TYPE 0.635(.025")	1/1
	CHECKED	Peterhu				
	APPROVED	John			DRAWING NO.	R-S117D-0

REV.	ZONE	LTR	DESCRIPTION	DATE	REVISER	APPD
------	------	-----	-------------	------	---------	------

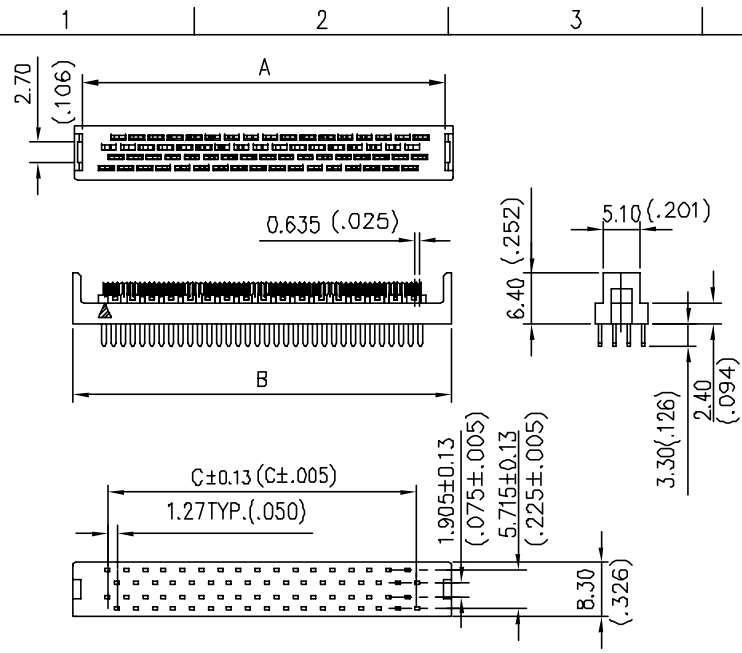

HOUSING & CONTACT ASSEMBLY

P.C.B LAYOUT

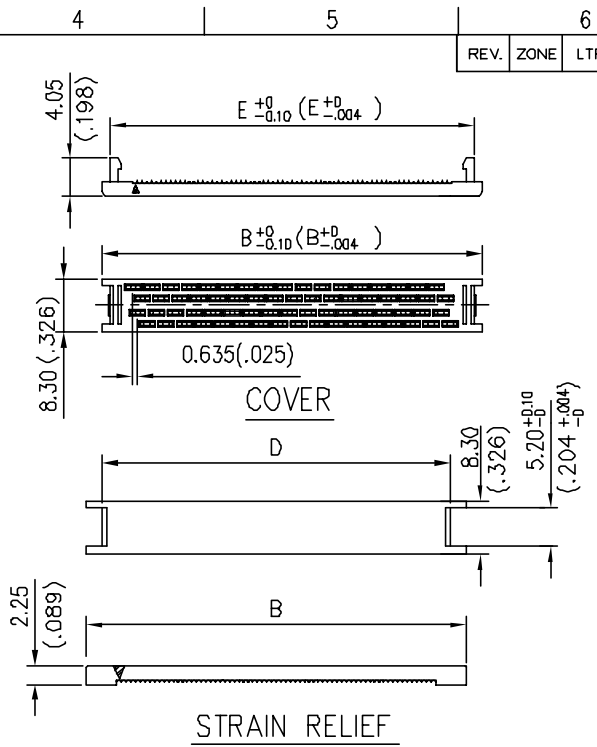

COVER

STRAIN RELIEF

ORDERING INFORMATION

- 17 DE *** 3 T * * - ** - AT
 (1) (2) (3) (4) (5) (6) (7) (8) (9)
- SERIES NUMBER : 17 DIP CONNECTOR
 - DE : 4ROWS 1.27(.050)*(.075) DIP'S I.D.C 0.635(0.025")FLAT CABLE
 - NO OF CONTACTS : 088 : 68 POSITIONS 080 : 80 POSITIONS
 - COLOR (INSULATOR) 3 : BLACK
 - CONTACT FINISH : T TIN PLATED
 - STRAIN RELIEF N: WITHOUT STRAIN RELIEF
 - PIN 1 LOCATION 1 : PIN 1 ON 1ST CONDUCTOR OF CABLE
 - SUFFIX NO. 00-WITHOUT LOGO 10-WITH "EDAING" LOGO
 - FINISHED PRODUCT NUMBER AT- LOW PROFILE TYPE

RoHS Compliant

NOTES:

- MATERIAL:
 HOUSING : PBT&30%G/F REINFORCED ,UL 94V-0
 STRAIN RELIEF : PBT&30%G/F REINFORCED,UL 94V-0
 COVER : PBT&30%G/F REINFORCED,UL 94V-0
 CONTACT : PHOSPHOR BRONZE,TIN PLATED OVER NICKEL
- SPECIFICATION
 . RATED CURRENT : 1A
 . INSULATION RESISTANCE : 1000M MIN. AT 500V DC.
 . CONTACT RESISTANCE : 35mΩ MAX.
 . DIELECTRIC WITHSTANDING VOLTAGE : AC 250V FOR 1 MIN.
 . OPERATING TEMPERATURE : -25°C - +85°C.

56.82(2.237)	54.72(2.154)	49.53(1.950)	59.12(2.327)	56.92(2.24)	17DE-080****
49.20(1.937)	47.10(1.854)	41.91(1.650)	51.50(2.027)	49.30(1.940)	17DE-068****
E	D	C	B	A	PART NO.
MATERIAL		TOLERANCE UNSPECIFIED		FREEPORT	
		.0 0 0 ± .0 0 ± 0.25(0.01) .0 ± 0.38(0.015) ± ± 1°		SCALE 1.4 : 1 UNIT mm(inch)	
FINISH		DRAWN MWLin 08/17/02		NAME 17DE SERIES SCSI-III H.D.	
		DESIGNER		I.D.C DIP TYPE 0.635(.025") (LOW PROFILE TYPE)	
		CHECKED Peterhu		DRAWING NO R-S117D-1	
		APPROVED JOHN		REV. 2	