

1	2		3	4	5	6	7	8			
CUSTOMER	CUST P/N	FREEPORT P/N			REV	ZONE	LTR	DESCRIPTION	DATE	REVISER	APPD
ALL(Customer)		1901139-xxx									

MATERIAL:

- 1)CONN:HDMI 19P/MALE 30U"/AU BLACK SHELL G/F PLATED SOLDER TYPE
With A(M) TO A(F) 90° PCB
- 2)CONN:HDMI 19P/FEMALE 30U"/AU BLACK SHELL G/F PLATED DIP TYPE
- 3)INNERMOLD:PE LOW DENSITY
- 4)OVERMOLD:PVC 70Pa BLACK UL94V-0

ELECTRICAL CHARACTER:

- 1)100% OPEN&SHORT TESTING
- 2)WITHSTANDING VOLTAGE:DC 300V 0.01Sec
- 3)INSULATION RESISTANCE:10M Ohm(Min)
- 4)CONDUCTIVE RESISTANCE:2 Ohm(Max)

ORDERING INFORMATION:

- 19 01139 - * * *
- [1] [2] [3] [4] [5]
- [1] SERIES NUMBER:
19:Adapter Series
 - [2] SEQUENCE NO.:
01139(EX. 01001-01999):HDMI (A)MALE TO (A)FEMALE ADAPTER(90 DEGREE)
 - [3] OUTER MOLDING COLOR CODES:
3:BLACK 4:WHITE 6:BLUE 7:RED 9:YELLOW
 - [4] PLATING OF SHELL:
1:SHELL PLATED GOLD
2:SHELL PLATED NI
 - [5] SUFFIX NO.:
A:WITH HDMI LOGO
B:WITHOUT LOGO

PIN ASSIGNMENT:

HDMI 19M(A)	HDMI 19F(B)
3	3 TMDs data2-
1	1 TMDs data2+
2	2 TMDs data2 Shield
6	6 TMDs data1-
4	4 TMDs data1+
5	5 TMDs data1 Shield
9	9 TMDs data0-
7	7 TMDs data0+
8	8 TMDs data0 Shield
12	12 TMDs Clock-
10	10 TMDs Clock+
11	11 TMDs Clock Shield
17	17 DDC/CEC Ground
13	13 CEC
15	15 SCL
16	16 SDA
14	14 Reserved
18	18 +5V Power
19	19 Hot Plug Detect
SHELL	SHELL

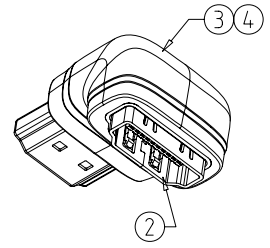
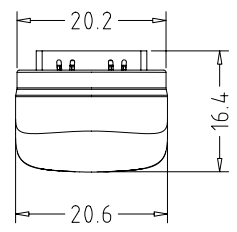
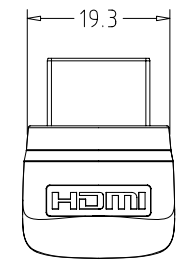
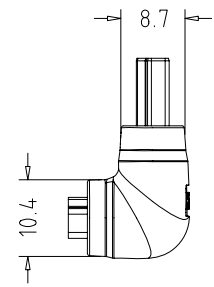
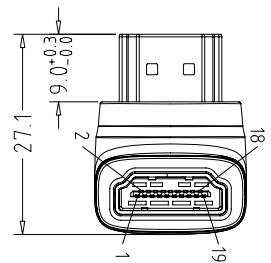
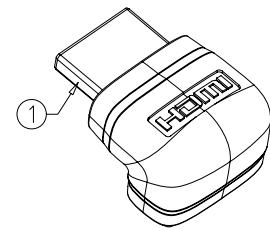
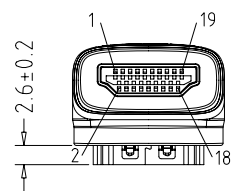

RoHS Compliant

MATERIAL 	TOLERANCE UNSPECIFIED .xxx ± .xx ± .x ± ± ANGLE ±	FREEPORT		
	FINISH 			SCALE NON
	DRAWN: Daniel	NAME		SHEET 1/1
	DESIGNER:	HDMI F-M 90 Degree Adapter		
CHECKED:	DRAWING NO.		REV 1.0	
APPROVED:	1901139			