

REV	ZONE	LTR	DESCRIPTION	DATE	REVISER	APPD
2.0	A3.C4	△	MODIFY DEMENSION:1.90 → 1.00 ADD DEMENSION: 2.70±0.10	4/9/08	Henry	
3.0	A2 D2.D4	△	MODIFY DEMENSION:1.90 → 1.00 ADD DEMENSION: 17.50±0.20 ADD DATE CODE	5/26.08	Regan	

ORDERING INFORMATION

51 V 019 S - 3 U W N - C - 5
 (1) (2) (3) (4) (5) (6) (7) (8) (9) (10)

- SERIES NO.
51: HDMI CONNECTOR
- TAIL CONSTRUCTION TYPE
V: VERTICAL SMT TYPE
- NUMBER OF PIN
019: 19 POSITIONS
- CONTACT & CONNECTIONG TYPES:
S: SOCKET
3: BLACK
- CONTACT PLATING:
5: THE CONTACT AREA 0.375um GOLD PLATED OVER NICKEL,SOLDER AREA GOLD FLASH PLATED OVER NICKEL.
6: THE CONTACT AREA 0.75um GOLD PLATED OVER NICKEL,SOLDER AREA GOLD FLASH PLATED OVER NICKEL.
U: THE CONTACT AREA 0.05um GOLD PLATED OVER NICKEL,SOLDER AREA GOLD FLASH PLATED OVER NICKEL.
- SHELL CONSTRUCTION
W: WITH WING
SOLDER TAIL IS THRU HOLE TYPE
- SHELL PLATING
T: TIN PLATED(LEAD FREE)
N: SOLDERABLE NICKEL PLATED
L: GOLD FLASH PLATED
- SUFFIX NO.1
B: WITHOUT FREEPORT LOGO
C: HOUSING AND SHELL WITH FREEPORT LOGO
- SUFFIX NO.2
5: WITH DIRTYPROOF AND BRACKET3

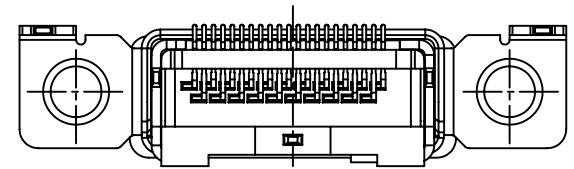
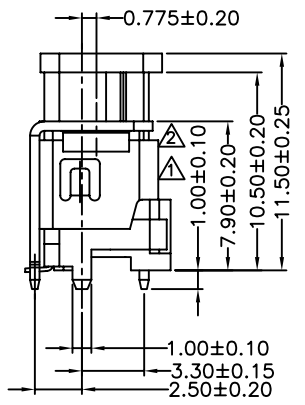
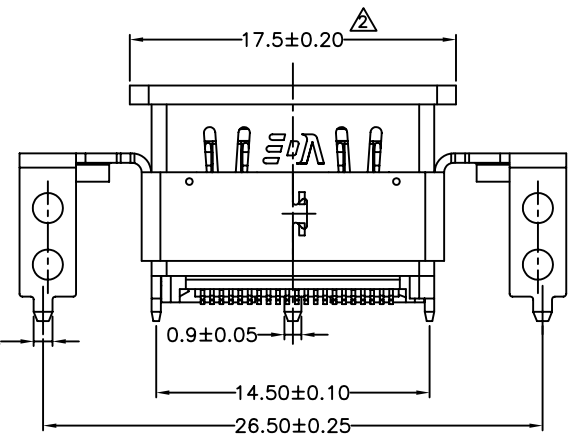
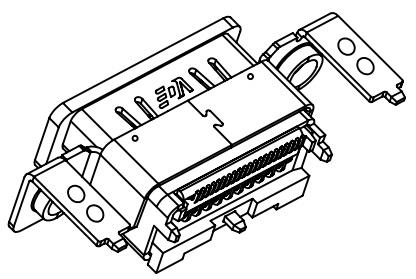
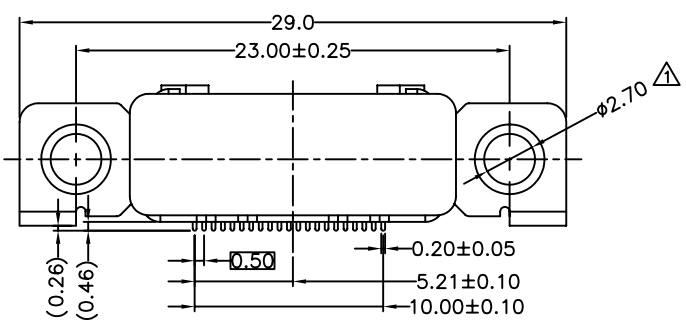
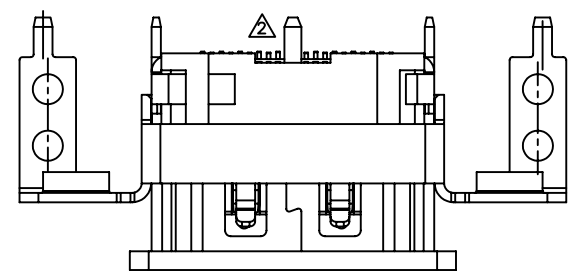

RoHS compliant

51V019S-3UWN-C5			PART NO.		
MATERIAL	TOLERANCE UNSPECIFIED . . . ±0.05 . . . ±0.10 . . . ±0.40 . . . ±0.80 ANGLE ± 1°			SCALE 1:1	UNIT mm
		DRAWN Mary 12/30/06 DESIGNER Mary 12/30/06 CHECKED Mlwin APPROVED Peter	NAME HDMI RECEPTACLE VERTICAL SMT TYPE DRAWING NO. R-S151V-15		SHEET 1/2
			A4 RS151V151		

REV	ZONE	LTR	DESCRIPTION	DATE	REVISER	APPD
2.0				4/9/08	Henry	
3.0				5/26.08	Henry	

COMPONENT, MATERIAL & SURFACE TREATMENT

(1). SHELL
 1. BRONZE
 2. NICKEL 1.27um (Min.)

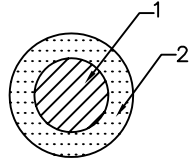

(2). CONTACT
 1. BRONZE
 2. NICKEL 0.51um (Min.)
 3. Au 0.05um (Min.)

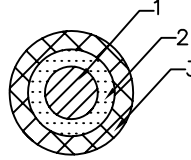

(3). DUMMY CONTACT
 1. BRONZE
 2. NICKEL 0.51um (Min.)
 3. Au 0.05um (Min.)

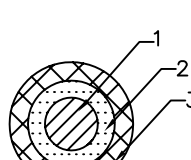
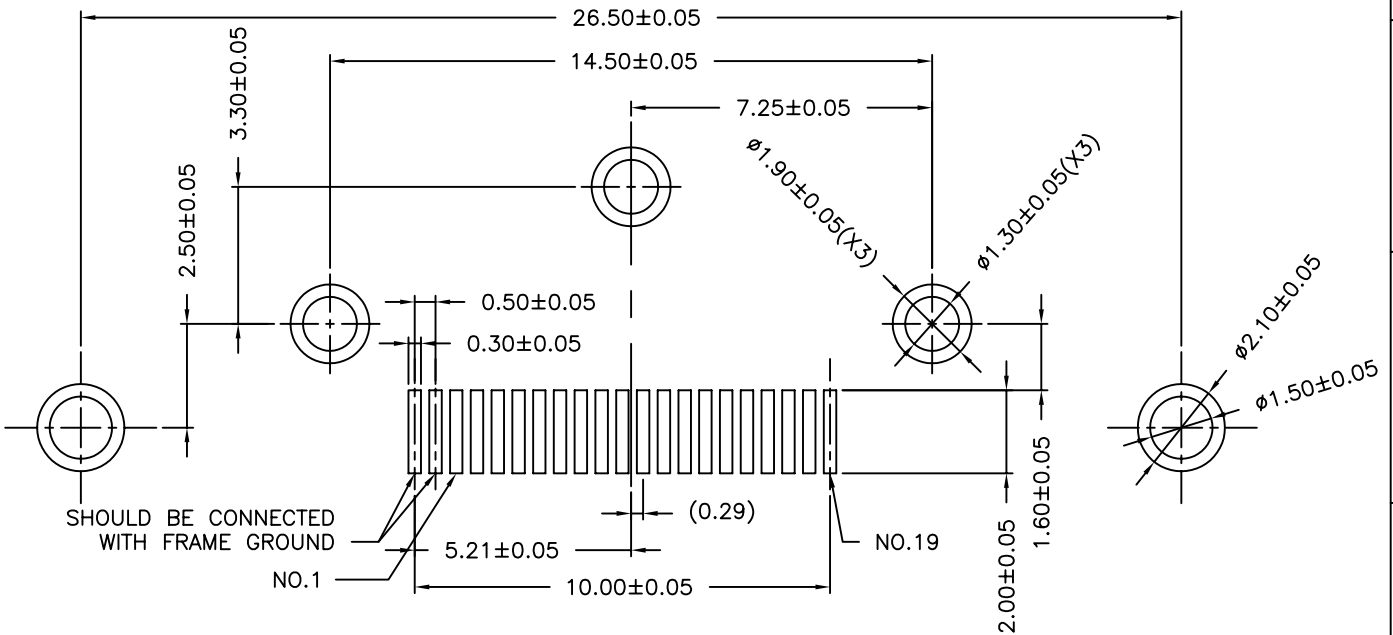



RECOMMENED P.C.B. LAYOUT (T=1.6mm)

REMARKS:

1. MATERIAL:
 - 1.1 INSULATOR: THERMOPLASTIC UL 94V-0 RATED, COLOR: BLACK
 - 1.2 CONTACT: COPPER ALLOY
 - 1.3 SHELL: COPPER ALLOY
 - 1.4 BRACKET: COPPER ALLOY
 - 1.5 DIRTYPROOF: THERMOPLASTIC UL94V-0 , COLOR: BLACK
2. PLATING:
 - 2.1 CONTACT: GOLD PLATED OVER NICKEL ON CONTACT AREA AND GOLD PLATED OVER NICKEL ON SOLDER TAILS
 - 2.2 SHELL & BRACKET: SOLDERABLE NICKEL OR TIN OR GOLD PLATED OVER NICKEL

RoHS compliant

MATERIAL	TOLERANCE UNSPECIFIED		 FREEPORT		SCALE	UNIT
	±0.05	±0.10				
	±0.40	±0.80	NAME	SHEET		
	ANGLE ±1°	DRAWN Mary 12/30/06			HDMI RECEPTACLE VERTICAL SMT TYPE	2/2
FINISH	DESIGNER Mary 12/30/06	DRAWING NO.	REV			
	CHECKED Mwlin			R-S151V-15	3.0	
	APPROVED Peter	A4 RS151V152				