

REV	ZONE	LTR	DESCRIPTION	DATE	REVISER	APPD
-----	------	-----	-------------	------	---------	------

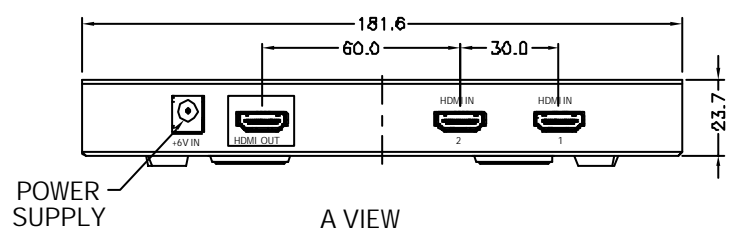
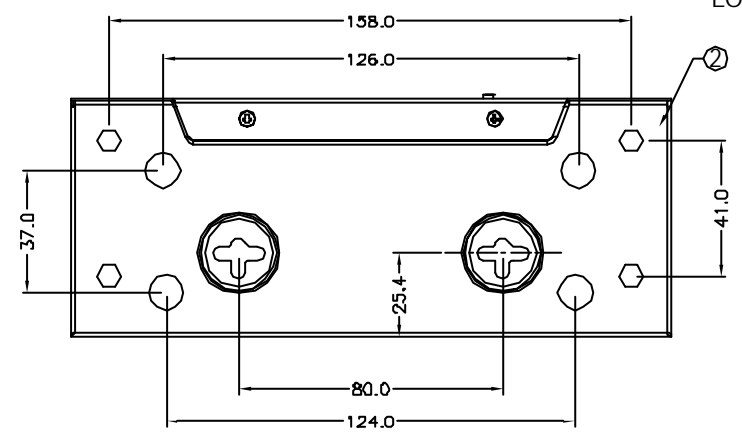
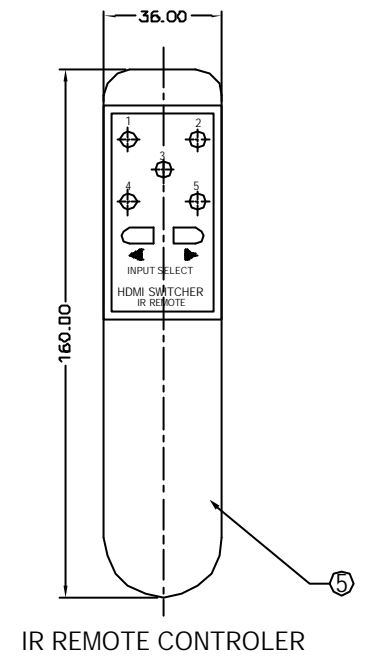
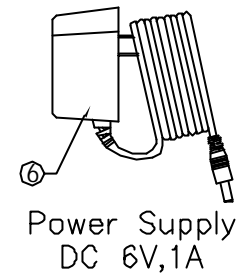
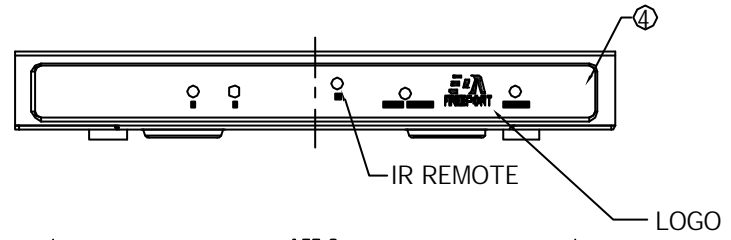
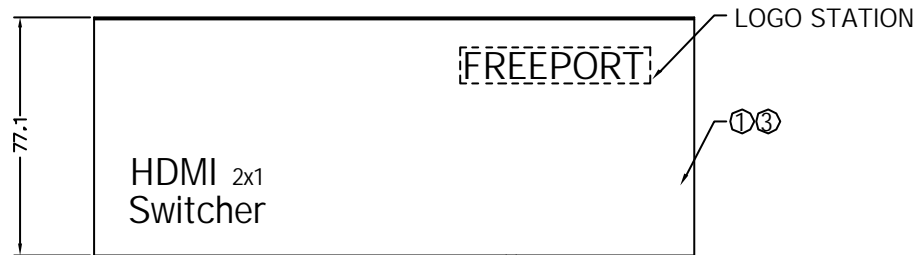

6	POWER SUPPLY	POWER SUPPLY	1PCS
5	IR REMOTE	IR REMOTE (160*36*16)	1PCS
4	FRONT PANEL	FRONT PANEL	1PCS
3	PCB ASSEMBLY	PCB ASSEMBLY	1PCS
2	BOTTOM SHELL	BOTTOM SHELL	1PCS
1	TOP SHELL	TOP SHELL	1PCS

NO.	PART NAME	SPEC DESCRIPTION	REMAKE	
MATERIAL	TOLERANCE UNSPECIFIED			
FINISH	± ± 0.25 ± 0.50 ± ANGLE ± 1°			SCALE NONE UNIT mm
	DRAWN	WRZ Jan26,06	NAME HDMI 2X1 SWITCHER	
	DESIGNER	WRZ Jan26,06		SHEET 1/2
	CHECKED			REV 0.2
APPROVED		DRAWING NO. R-S1HS-3		

REV	ZONE	LTR	DESCRIPTION	DATE	REVISER	APPD
2		⚠	國家標準增加香港以及日本插頭	08/01/26	WRZ	

ORDERING INFORMATION:

$\frac{HS}{(1)}$
 $\frac{*}{(2)}$
 $\frac{*}{(3)}$
 $\frac{-}{(4)}$
 $\frac{*}{(5)}$
 $\frac{*}{(6)}$
 $\frac{-}{(7)}$

- (1) SERIES NUMBER:
HS : HDMI SWITCHER
- (2) INPUT PORT QUANTITY
2 : 2 INPUT PORT
- (3) OUTPUT PORT QUANTITY
1 : 1 OUTPUT PORT
- (4) COLOR NO. :
1:BLUE 2:GRAY 3:BLACK
- (5) FRONT PANEL :
1:BLACK COLOR IN WHITE LETTER
2:SILVER WHITE COLOR IN BLACK LETTER
- (6) SUFFIX NO. :
A:WITH "FREEPORT" LOGO
- (7) POWER SUPPLY TYPE :
AU:AUSTRALIA TYPE,WITH SAA CERTIFICATE
UL:USA TYPE,WITH UL CERTIFICATE
CE:EUROPE TYPE,WITH CE CERTIFICATE
BS:HK&UK TYPE,WITH BS/CE CERTIFICATE
JA:JAPAN TYPE,WITH PSE CERTIFICATE

Technical Details:

1. Easy switching of multiple HDMI sources by using remote control or the switch button on the switcher.
2. Frequency Bandwidth: 1.65 Gbps
3. Individual LED Display of video source channels.
4. Maintains highest HDMI single link video resolution: Supports HDTV resolution of 480p, 720p, 1080i and 1080p & Supports VGA, SVGA, SXGA(1280x1024), UXGA(1600x1200) and 1920x1200.
5. Supports DDWG standard for HDMI compliant monitors.
6. Inputs: Two Type A 19-pin HDMI female ports
7. Output: One Type A 19-pin HDMI female port
8. Power supply: DC 6V,1A Adaptor Included
9. Plug-and-play. No software installation required.
10. Supports long length cable application.



AU

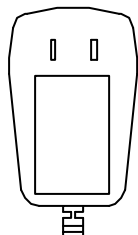

USA

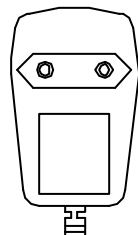

EUROPE

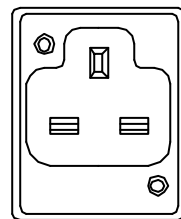

HK&UK

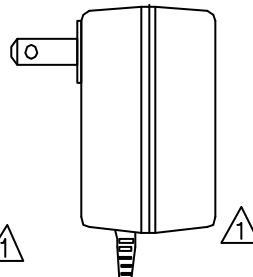

JAPAN

MATERIAL	TOLERANCE UNSPECIFIED		
FINISH	±	SCALE	UNIT
	±	NONE	mm
	±	NAME	SHEET
	±	HDMI 2X1 SWITCHER	2/2
	ANGLE	DRAWING NO.	REV
	±	R-S1HS-3	0.2
	DRAWN WRZ Jan26,06	A4 RS1HS32	
	DESIGNER WRZ Jan26,06		
	CHECKED		
	APPROVED		